

Sierra Ridge

Community Map



Details make a difference at Sierra Ridge.

From luxurious modern amenities to energy-saving features, everything you want in a home is already included.

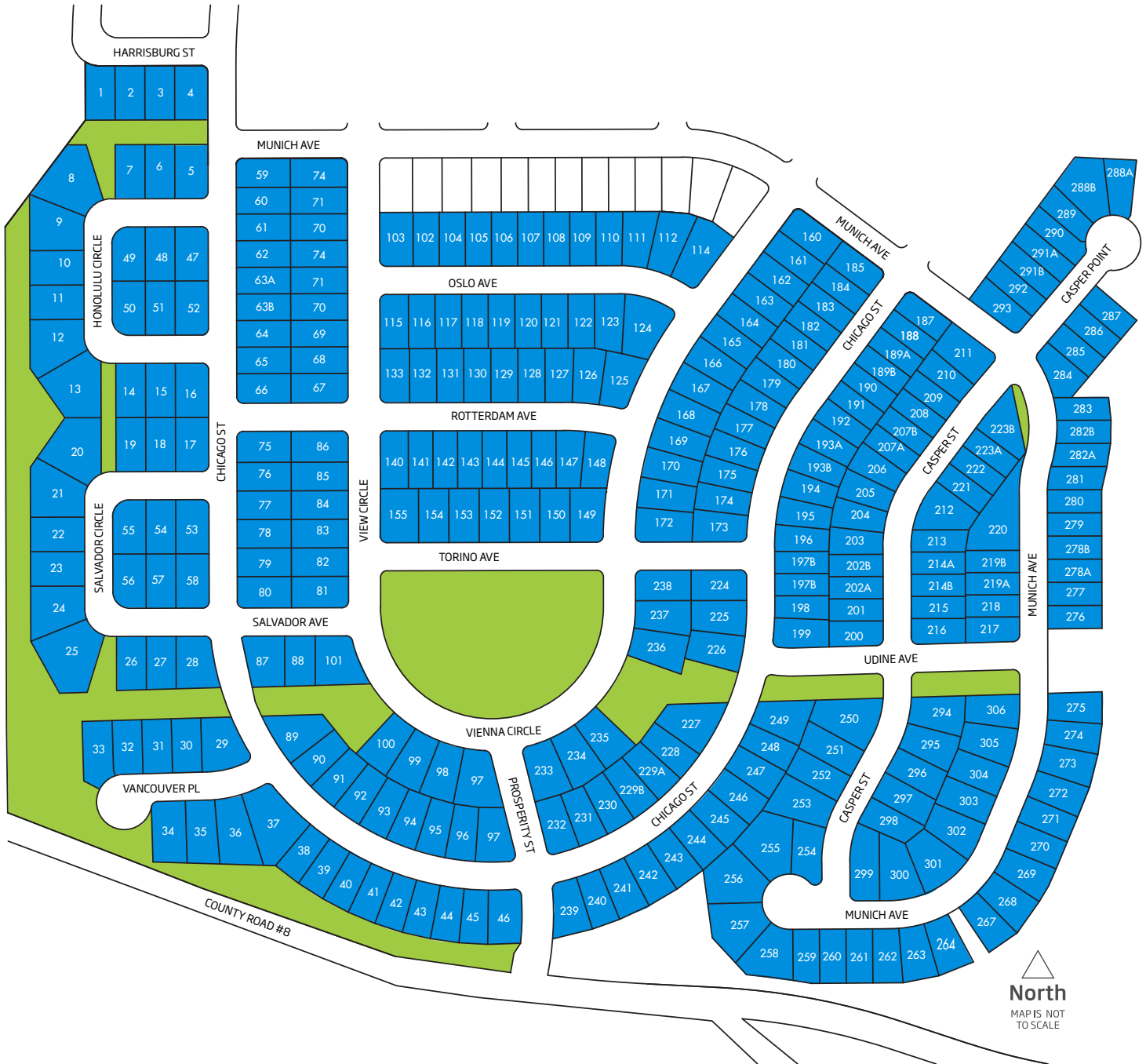

9989 Isle Circle | Parker CO 80134 | 720-619-0200 | Lennar.com/Colorado



Site plans and community maps are conceptual in nature and are merely an artist's rendition. These maps are solely for illustrative purposes and should never be relied upon. The past, present, future or proposed roads, easements, land uses, conditions, plat maps, lot sizes or layouts, zoning utilities, drainage, land conditions or development of any type whatsoever, whether reflected on the site plan or map, or whether outside the boundaries of the site plan or map, may not be shown or may be incomplete or inaccurate. The past, present, future or proposed roads, easements, land uses, conditions, plat maps, lot sizes or layouts, zoning utilities, drainage, land conditions or development of any type may or may not change in the future. It is not uncommon that any of the foregoing can change without notice to you. You should never rely on the accuracy of this map in making decisions relative to purchasing any property. We reserve the right to make changes at any time without notice. Map not to scale. Copyright © 2017 Lennar Corporation. All rights reserved. Lennar, the Lennar logo, and the Everything's Included logo are registered service marks or service marks of Lennar Corporation and/or its subsidiaries. 5/17